

**FLOAT FLOWMETER
WITH REGULATION VALVE**

FLOAT FLOWMETER WITH REGULATION VALVE

They are instruments to measure the instantaneous flow.

The system of operation is by a conical tube and a float inside. When the liquid goes through the inside of the tube and when the flow increases, it makes a force on the float that allows to calculate the flow through the graduated scale on the tube.

The body is manufactured in a resistant and transparent plastic. The float is usually acrylic or stainless.

The connection is 1/4" BSP Female to which a connection of chromed brass M 18 x 1, 5 has been attached. As an option this connection can be in Stainless Steel.

The regulating valve is in stainless steel with the handle in plastic and the joints in silicone rubber.

The temperature of the water must be between 0 and 60°C because the element has been calibrated at 20°C.

Maximum pressure: equal or less than 6 bar
Accuracy: 4%



Range liquid ml/min	Range (Gas) l/m
16-160	1-5
80-400	2-10
100-500	3-15
100-600	4-20
200-800	5-25
100-1000	6-30

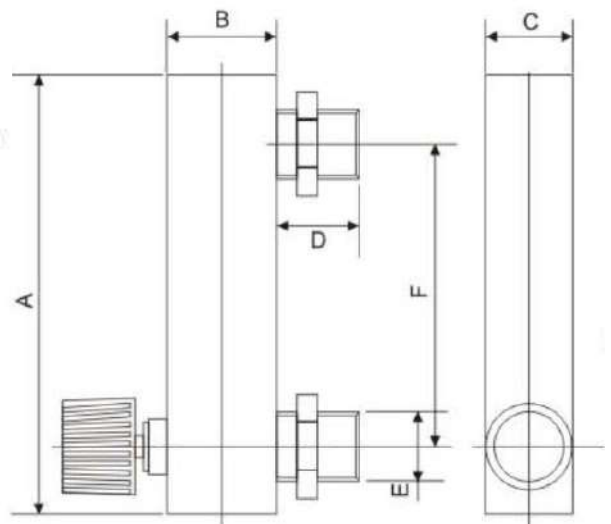
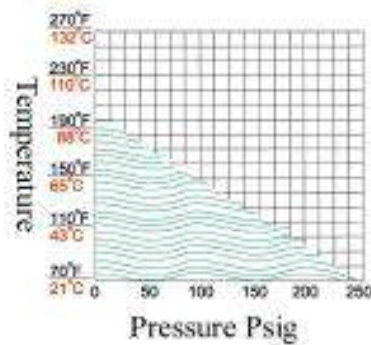

A	B	C	D	E	F
102mm	30 mm	25 mm	20mm	M 18x1,5	77 mm

This publication does not try to establish the bases of a contract and the company keeps the right to modify without previous notice the design and the specifications of the instruments, in accordance with his politics of continued development.